

CM-254-D-3x (XX) -2- (YY) - A/B/C

(XX) = N = number of contacts per row between 02 and 50

Put the desired dimensions for A, B and C in mm unit

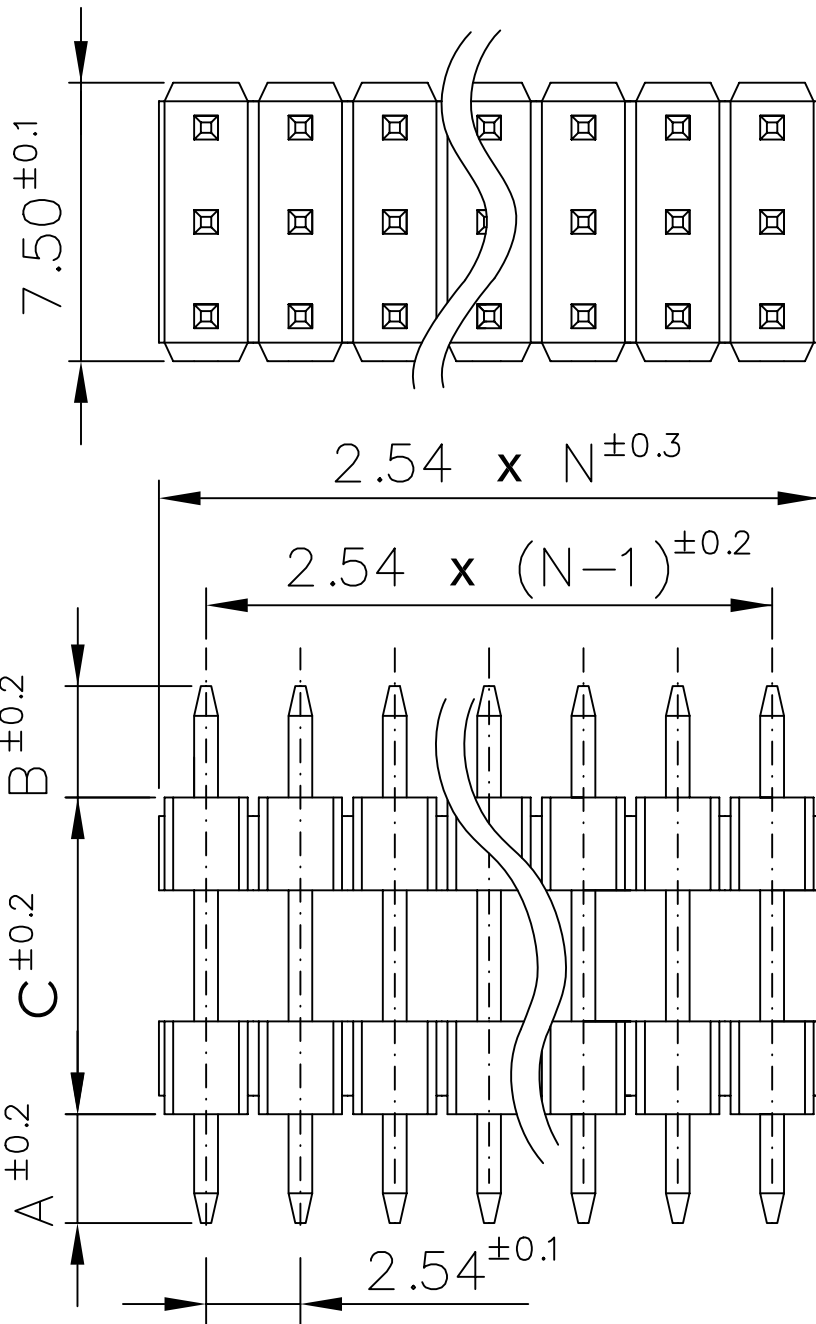

Plating:

- (YY) = FG = gold flash
- (YY) = G1 = gold 0.12µm
- (YY) = G2 = gold 0.25µm
- (YY) = G3 = gold 0.50µm
- (YY) = G4 = gold 0.75µm
- (YY) = TF = pure tin flash
- (YY) = T1 = pure tin 5µm
- (YY) = FS = selective gold flash
- (YY) = S1 = selective gold 0.12µm
- (YY) = S2 = selective gold 0.25µm
- (YY) = S3 = selective gold 0.50µm
- (YY) = S4 = selective gold 0.75µm

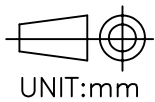
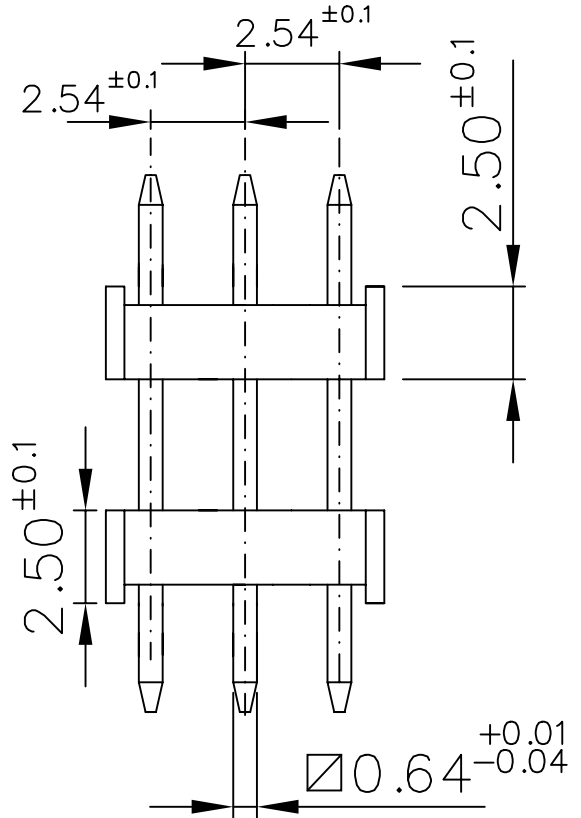

ELECTRICAL PROPERTIES
 Current rate: 3 Ampère
 Insulation resistance: 5000MΩ min.
 Contact resistance: 10mΩ max.
 Dielectric Voltage: 500V AC for 1 minute

MECHANICAL PROPERTIES
 Operating temperature: -40°C ÷ +105°C
 Peak temperature: 160° for 5+10 sec
 PCB recommended holes: ∅1.02mm

INDEX	DATE	MODIFICATION OCCURRED		VISA
TOLERANCES FOR FREE DIMENSIONS				Material: copper alloy Insulator: Nylon 6T (UL94V0)
ANGULAR VALUES	FROM 0.5 TO 3.0	FROM >3.0 TO 6.0	FROM >6.0 TO 10.0	Date of creation 16-02-06
	FROM >10.0 TO 18.0	FROM >18.0 TO 30.0	FROM >30.0 TO 50.0	
±2°	±0.125	±0.150	±0.180	Designer Chiappini R.
	±0.215	±0.260	±0.310	
	±0.370	±0.435	±0.500	
	±0.575	±0.650		
Notes: --				

Part number: CM-254-D-3x (XX) -2- (YY) -A/B/C

Drawing number: _____

Index: _____

File: _____

Description: Triple row straight double insulator male connector pitch 2.54mm



QUESTO DISEGNO È DI PROPRIETÀ DELLA DITTA FIORTECH E NON PUÒ ESSERE USATO, E/O CEDUTO A TERZI SENZA IL PERMESSO SCRITTO DELLA FIORTECH
 THIS DRAWING IS THE PROPERTY OF FIORTECH FACTORY AND IT CAN NOT BE USED, REPRODUCED AND OR LOANED TO THIRD PARTIES WITHOUT THE WRITTEN PERMISSION OF FIORTECH