

**Plating:**

- (Y) = FG = gold flash
- (Y) = G1 = gold 0.12µm
- (Y) = G2 = gold 0.25µm
- (Y) = G3 = gold 0.50µm
- (Y) = G4 = gold 0.75µm
- (Y) = TF = pure tin flash
- (Y) = T1 = pure tin 5µm
- (Y) = FS = selective gold flash
- (Y) = S1 = selective gold 0.12µm
- (Y) = S2 = selective gold 0.25µm
- (Y) = S3 = selective gold 0.50µm
- (Y) = S4 = selective gold 0.75µm

(XX) = N = number of contacts between 02 and 50

Put the desired dimensions for A, B and C in mm unit

**CM-254-S-1x (XX) -1- (YY) - A/B/C**

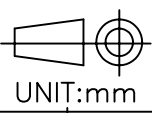

**ELECTRICAL PROPERTIES**  
 Current rate: 3 Ampère  
 Insulation resistance: 5000MΩ min.  
 Contact resistance: 10mΩ max.  
 Dielectric Voltage: 500V AC for 1 minute

**MECHANICAL PROPERTIES**  
 Operating temperature: -40°C ÷ +105°C  
 Peak temperature: 160° for 5÷10 sec  
 PCB recommended holes: ∅1.02mm

**DIMENSIONS (see also "notes")**  
 2.3mm ; 2.5mm ; 3.3mm  
 are available for "C" dimension  
 Standard "B" dimension: 5.0mm

INDEX	DATE	MODIFICATION OCCURRED	VISA Scale
-------	------	-----------------------	------------

TOLERANCES FOR FREE DIMENSIONS											
ANGULAR VALUES	FROM 0.5 TO 3.0	FROM >3.0 TO 6.0	FROM >6.0 TO 10.0	FROM >10.0 TO 18.0	FROM >18.0 TO 30.0	FROM >30.0 TO 50.0	FROM >50.0 TO 80.0	FROM >80.0 TO 120.0	FROM >120.0 TO 180.0	FROM >180.0 TO 250.0	FROM >250.0 TO 315.0
±2°	±0.125	±0.150	±0.180	±0.215	±0.260	±0.310	±0.370	±0.435	±0.500	±0.575	±0.650

Material: Pin: copper alloy  
Insulator: Nylon 6T (UL94V0)  
 Insulator height for C dimensions: 1.5mm when C is 2.3  
 1.7mm when C is 2.5 or 2.5mm when C is 3.3  
 Cap for pick 'n' place and tape and reel packaging available. Inverted pin #1 available on demand

Date of creation: 16-02-06  
 Designer: Chiappini R.

Part number: CM-254-S-1x (XX) -1- (YY) -A/B/C

Drawing number: \_\_\_\_\_

Index: \_\_\_\_\_

File: \_\_\_\_\_

Description: Single row SMD male connector pitch 2.54mm

