

THIS DRAWING IS THE PROPERTY OF FIORTECH FACTORY AND IT CAN NOT BE USED, REPRODUCED AND OR LOANED TO THIRD PARTIES WITHOUT THE WRITTEN PERMISSION OF FIORTECH

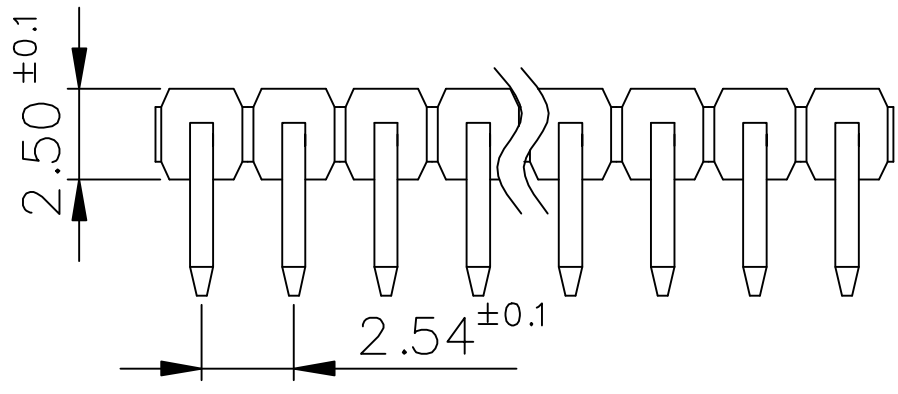
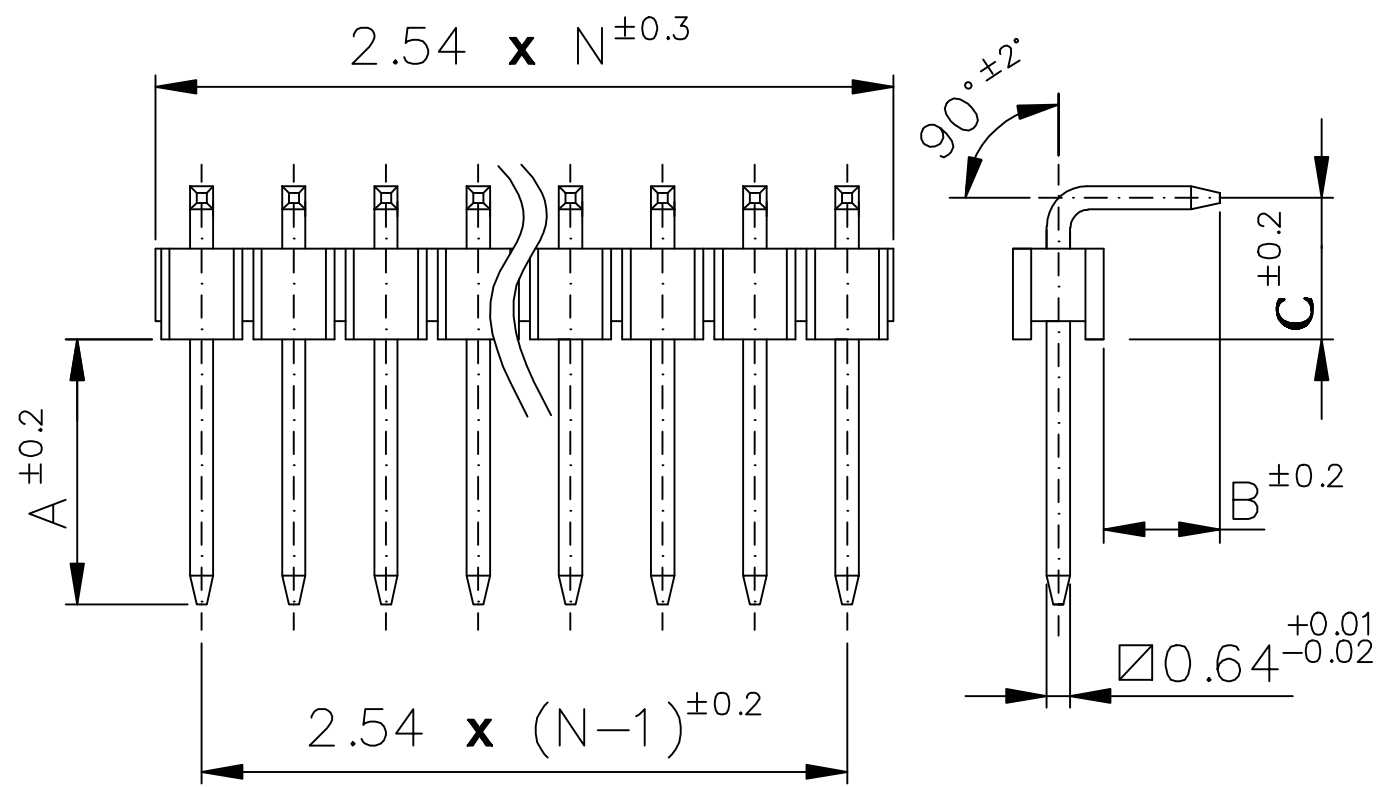

Plating:

- (YY) = FG = gold flash
- (YY) = G1 = gold 0.12µm
- (YY) = G2 = gold 0.25µm
- (YY) = G3 = gold 0.50µm
- (YY) = G4 = gold 0.75µm
- (YY) = TF = pure tin flash
- (YY) = T1 = pure tin 5µm
- (YY) = FS = selective gold flash
- (YY) = S1 = selective gold 0.12µm
- (YY) = S2 = selective gold 0.25µm
- (YY) = S3 = selective gold 0.50µm
- (YY) = S4 = selective gold 0.75µm

Put the desired dimensions for A, B and C in mm unit

(XX) = N = number of contacts between 02 and 50

CM-254-A-1x (XX) -1- (YY) - A/B/C

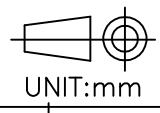

ELECTRICAL PROPERTIES
 Current rate: 3 Ampère
 Insulation resistance: 5000MΩ min.
 Contact resistance: 10mΩ max.
 Dielectric Voltage: 500V AC for 1 minute

MECHANICAL PROPERTIES
 Operating temperature: -40°C + +105°C
 Peak temperature: 160° for 5+10 sec
 PCB recommended holes: ø1.02mm

INSULATOR HEIGHT
 1.5mm ; 1.7mm ; 2.5mm are available.
 To be specified separately

INDEX	DATE	MODIFICATION OCCURRED										VISA
TOLERANCES FOR FREE DIMENSIONS											Material <u>Pin: copper alloy</u> <u>Insulator: Nylon 6T (UL94V0)</u>	VISA Scale
ANGULAR VALUES	FROM 0.5 TO 3.0	FROM >3.0 TO 6.0	FROM >6.0 TO 10.0	FROM >10.0 TO 18.0	FROM >18.0 TO 30.0	FROM >30.0 TO 50.0	FROM >50.0 TO 80.0	FROM >80.0 TO 120.0	FROM >120.0 TO 180.0	FROM >180.0 TO 250.0		
±2°	±0.125	±0.150	±0.180	±0.215	±0.260	±0.310	±0.370	±0.435	±0.500	±0.575	±0.650	16-02-06
Notes: --											Designer Chiappini R.	

Part number: CM-254-A-1x (XX) -1- (YY) -A/B/C

Drawing number: _____

Index: _____

File: _____

Description: _____
 Single row right angle
 male connector pitch 2.54mm



QUESTO DISEGNO E' DI PROPRIETA' DELLA DITTA FIORTECH E NON PUO' ESSERE USATO, E/O CEDUTO A TERZI SENZA IL PERMESSO SCRITTO DELLA FIORTECH