

THIS DRAWING IS THE PROPERTY OF FIORTECH FACTORY AND IT CAN NOT BE USED, REPRODUCED AND OR LOANED TO THIRD PARTIES WITHOUT THE WRITTEN PERMISSION OF FIORTECH

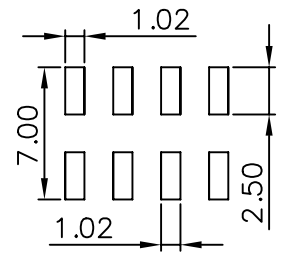
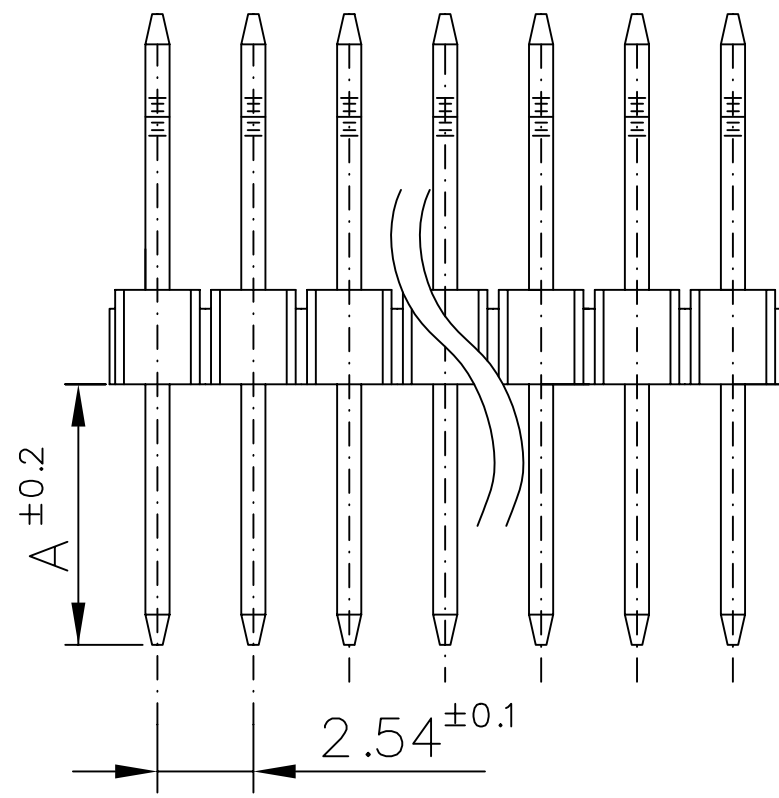
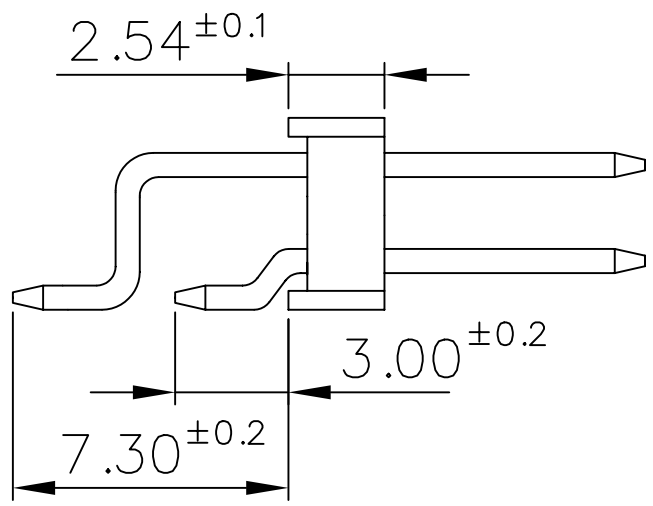
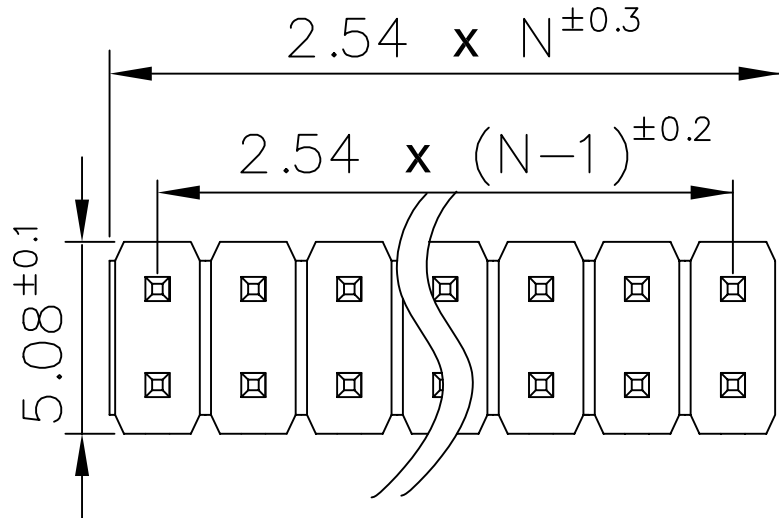

Recommended PCB layout (Tolerance ±0.05)

Plating:

- (YY) = FG = gold flash
- (YY) = G1 = gold 0.12µm
- (YY) = G2 = gold 0.25µm
- (YY) = G3 = gold 0.50µm
- (YY) = G4 = gold 0.75µm
- (YY) = TF = pure tin flash
- (YY) = T1 = pure tin 5µm
- (YY) = FS = selective gold flash
- (YY) = S1 = selective gold 0.12µm
- (YY) = S2 = selective gold 0.25µm
- (YY) = S3 = selective gold 0.50µm
- (YY) = S4 = selective gold 0.75µm

Put the desired dimension for A in mm unit

(XX) = N = number of contacts between 03 and 30

CM-254-H-2x (XX) -1- (YY) - A

QUESTO DISEGNO È DI PROPRIETÀ DELLA DITTA FIORTECH E NON PUO' ESSERE USATO, E/O CEDUTO A TERZI SENZA IL PERMESSO SCRITTO DELLA FIORTECH

		ELECTRICAL PROPERTIES Current rate: 3 Ampère Insulation resistance: 5000MΩ min. Contact resistance: 10mΩ max. Dielectric Voltage: 500V AC for 1 minute				MECHANICAL PROPERTIES Operating temperature: -40°C ± +105°C Peak temperature: 160° for 5+10 sec PCB recommended holes: ø1.02mm							
INDEX	DATE	MODIFICATION OCCURRED						VISA	Scale				
TOLERANCES FOR FREE DIMENSIONS								Material: <u>Pin: copper alloy Insulator: Nylon 6T (UL94V0)</u>					
ANGULAR VALUES	FROM 0.5 TO 3.0	FROM >3.0 TO 6.0	FROM >6.0 TO 10.0	FROM >10.0 TO 18.0	FROM >18.0 TO 30.0	FROM >30.0 TO 50.0	FROM >50.0 TO 80.0	FROM >80.0 TO 120.0	FROM >120.0 TO 180.0	FROM >180.0 TO 250.0	FROM >250.0 TO 315.0	Material	Date of creation
±2°	±0.125	±0.150	±0.180	±0.215	±0.260	±0.310	±0.370	±0.435	±0.500	±0.575	±0.650	Plating	16-02-06
Notes: ---												Designer	Chiappini R.

Part number: CM-254-H-2x (XX) -1- (YY) - A

Drawing number: _____

Index: _____

File: _____

Description: Double row horizontal SMD male connector pitch 2.54mm

