

THIS DRAWING IS THE PROPERTY OF FIORTECH FACTORY AND IT CAN NOT BE USED, REPRODUCED AND OR LOANED TO THIRD PARTIES WITHOUT THE WRITTEN PERMISSION OF FIORTECH

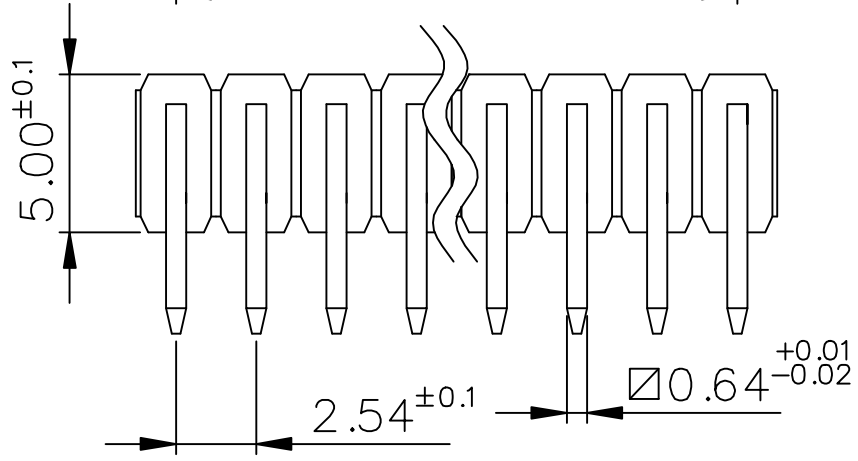
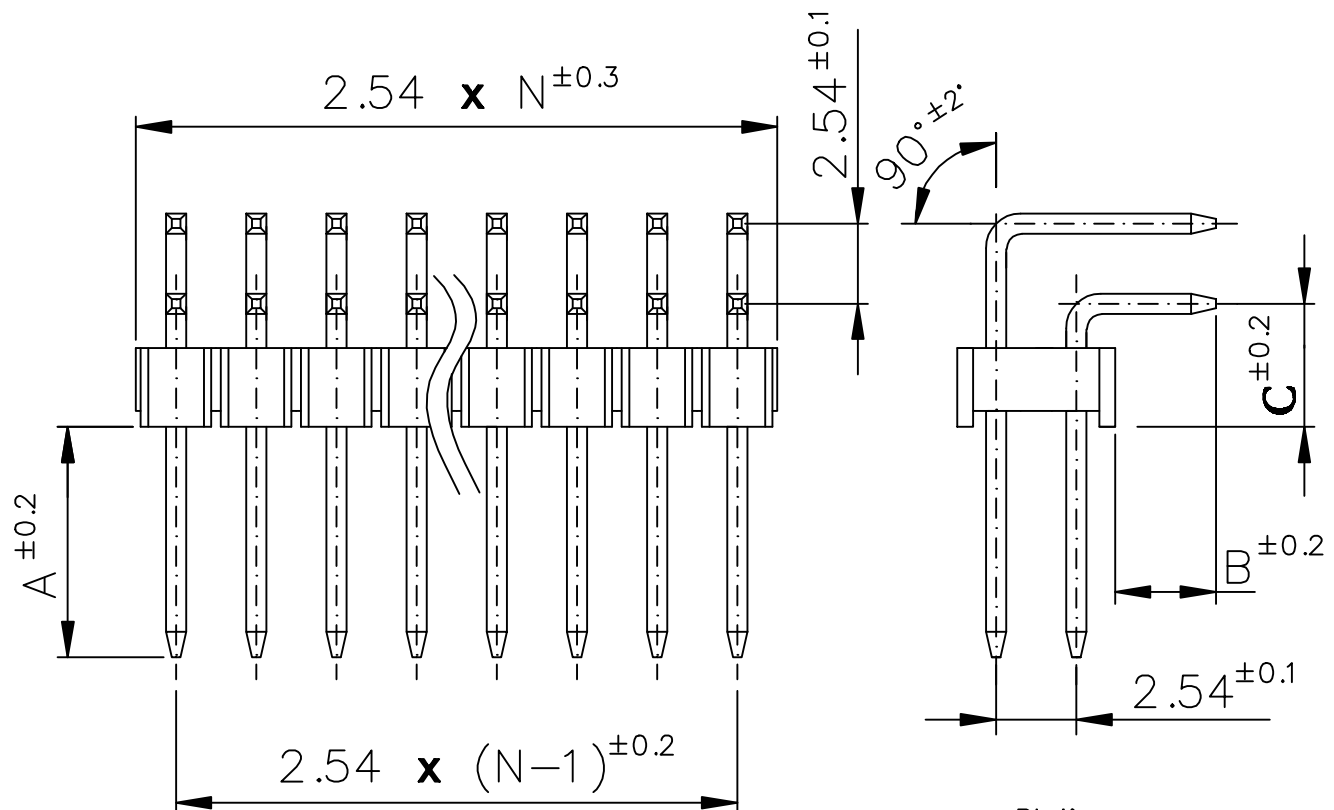

Plating:

- (YY) = FG = gold flash
- (YY) = G1 = gold 0.12µm
- (YY) = G2 = gold 0.25µm
- (YY) = G3 = gold 0.50µm
- (YY) = G4 = gold 0.75µm
- (YY) = TF = pure tin flash
- (YY) = T1 = pure tin 5µm
- (YY) = FS = selective gold flash
- (YY) = S1 = selective gold 0.12µm
- (YY) = S2 = selective gold 0.25µm
- (YY) = S3 = selective gold 0.50µm
- (YY) = S4 = selective gold 0.75µm

Put the desired dimensions for A, B and C in mm unit

(XX) = N = number of contacts per row between 02 and 50

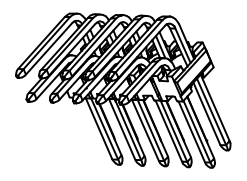

CM-254-A-2x (XX) -1- (YY) - A/B/C

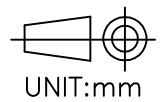

ELECTRICAL PROPERTIES
 Current rate: 3 Ampere
 Insulation resistance: 1000MΩ min.
 Contact resistance: 20mΩ max.
 Dielectric Voltage: 1000V AC for 1 minute

MECHANICAL PROPERTIES
 Operating temperature: -40°C + 105°C
 PCB recommended holes: ø1.02mm

INSULATOR HEIGHT
 1.5mm ; 1.7mm ; 2.5mm are available.
 To be specified separately

INDEX	DATE	MODIFICATION OCCURRED		VISA
TOLERANCES FOR FREE DIMENSIONS				VISA
ANGULAR VALUES	FROM 0.5 TO 3.0	FROM >3.0 TO 6.0	FROM >6.0 TO 10.0	Material Pin: copper alloy Insulator: P.B.T.
±2°	±0.125	±0.150	±0.180	Plating See table
	±0.215	±0.260	±0.310	Notes: --
	±0.370	±0.435	±0.500	Notes: --
	±0.575	±0.650		
				Date of creation 16-02-06
				Designer Chiappini R.

Part number: **CM-254-A-2x (XX) -1- (YY) -A/B/C**

Drawing number: _____

Index: _____

File: _____

Description: **Double row right angle male connector pitch 2.54mm**



QUESTO DISEGNO E' DI PROPRIETA' DELLA DITTA FIORTECH E NON PUO' ESSERE USATO, E/O CEDUTO A TERZI SENZA IL PERMESSO SCRITTO DELLA FIORTECH